

PLAT OF SURVEY

LOCATION: N3174 Larch Road, Lake Geneva, Wisconsin

LEGAL DESCRIPTION:

Lots 6659 thru 6661 in Block 114 of **LAKE COMO BEACH**, being a part of the Section 21 & 28, in Town 2 North, Range 17 East, in the Town of Geneva, Walworth County, Wisconsin.

July 17, 2020

Survey No. 111259-B

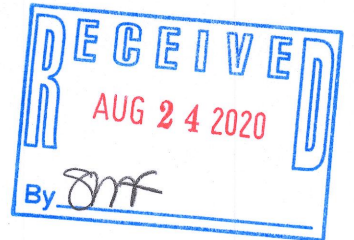
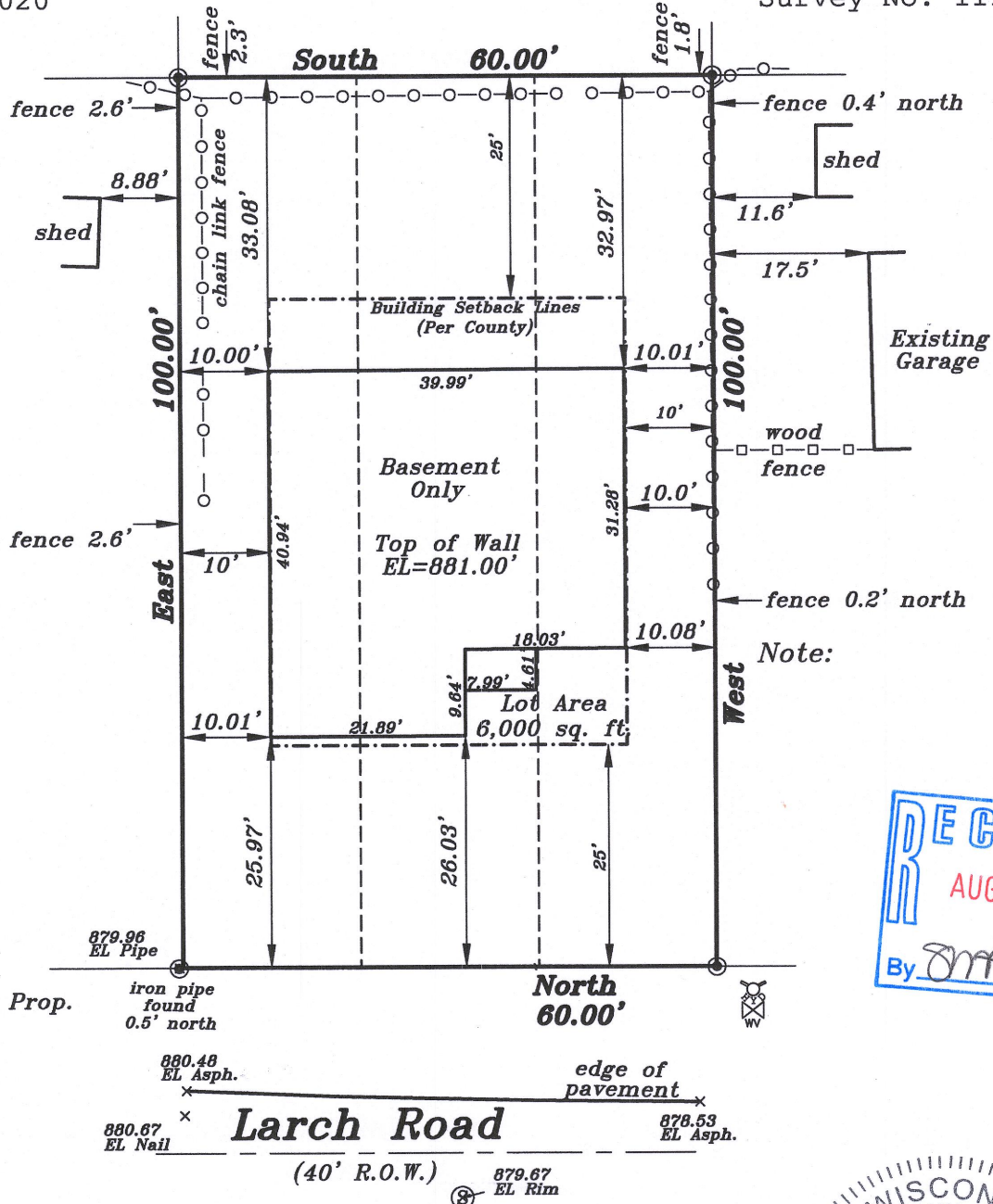

Prop.
Gar. Slab
880.67'

T.O.W.
881.0'

Prop. Fin.
Yd. Gr.
880.33'
(Per Builder)

GRAPHIC SCALE

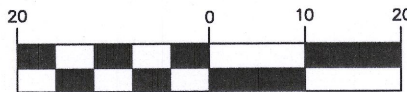

(IN FEET)
1 inch = 20 ft.

Proposed finished yard, 1st floor or top of foundation grade shown on this drawing is a suggested grade and should be verified by the owner, builder or municipality

METROPOLITAN SURVEY SERVICE, INC.

PROFESSIONAL LAND SURVEYORS AND CIVIL ENGINEERS

9415 West Forest Home Avenue, Suite 202
Hales Corners, Wisconsin 53130

PH. (414) 529-5380 FAX (414) 529-9787
email address: survey@metropolitansurvey.com

- ⊙ — Denotes Iron Pipe Found
- — Denotes Iron Pipe Set

I HEREBY CERTIFY THAT I HAVE SURVEYED THE ABOVE DESCRIBED PROPERTY AND THAT THE ABOVE MAP IS A TRUE REPRESENTATION THEREOF AND SHOWS THE SIZE AND LOCATION OF THE PROPERTY. ITS EXTERIOR BOUNDARIES, THE LOCATION OF ALL VISIBLE STRUCTURES AND DIMENSIONS OF ALL PRINCIPAL BUILDINGS THEREON, BOUNDARY FENCES, APPARENT EASEMENTS AND ROADWAYS AND VISIBLE ENCROACHMENT, IF ANY.

THIS SURVEY IS MADE FOR THE EXCLUSIVE USE OF THE PRESENT OWNERS OF THE PROPERTY, AND ALSO THOSE WHO PURCHASE, MORTGAGE, OR GUARANTEE THE TITLE THERETO WITHIN ONE (1) YEAR FROM THE DATE HEREOF.

SIGNED

Dennis C. Sauer

Professional Land Surveyor S-2421

217-4667

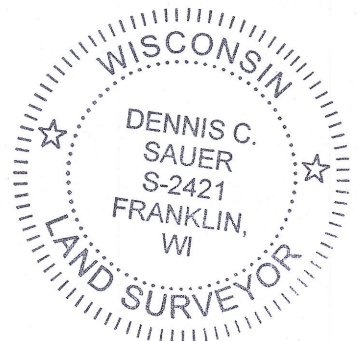

JLCB-1394